

# CL-1TD Ceiling Speaker Instruction Manual



The CL-1TD is a compact coaxial ceiling speaker designed to be both aesthetically invisible and give a smooth linear sound. The ceiling speaker blends in with its surroundings whilst the full range response from OHM's proprietary drivers creates a fuller, richer, tone with the added protection of a fire dome enclosure.

CL-1TD is designed with the listener and installer in mind. The coaxial drivers give an even 140° conical dispersion ensuring wide coverage while the full range driver gives extra depth to any source. Integrated quick-lock brackets and push connectors for input signal make installation easy.

With a 30 watt, 5" woofer, the CL-1TD can be used as 8 Ohm or 100 V using the supplied transformer with 2.5, 5, 10, 20 Watt (100 V) tapping.

The diameter of Ø203 mm x 145 mm deep makes this ceiling speaker very discreet. With a frequency range of 50 Hz - 20 kHz, the CL-1TD is capable of most playback scenarios where discretion is required.

The final look of the CL-1TD is an attractive white colour ABS resin finish with complementary grill that is designed to blend into any décor.

Two push fit speaker cable terminals are mounted at the back of the fire dome housing. Com and Input. Voltage and tapping are selectable by turning the toggle switch to the desired setting.

## Key Features:

- Quick-lock system ensures easy installation
- Wide dispersion pattern
- Multiple sizes offer response and SPL to meet all requirements

- EN 62368-1:2014/AC:2015
- EN 62479:2010
- ETSI EN 301 489-1 V2.1.1 (2017-02)
- ETSI EN 301 489-17 V3.1.1 (2017-02)
- The CL-1T complies with the essential requirements of directive 2014/53/EU article 3.

## Conformity Details:

# Technical Specifications

## Design

5" Full Range

## Impedance

8Ω / 100V

## Tapping Watts

2.5, 5, 10, 20

## Power Handling (RMS)

15 Watts (continuous)

## Max. Power Handling (RMS)

30 Watts (program)

60 Watts (peak 10 ms)

## Sensitivity 2.83V / 1m

85 dB

## Max. SPL

99 dB (cont. max SPL / 1m)

105 dB peak

## Frequency Response ±3 dB

50 Hz - 20 kHz

## Dispersion

140° Conical

## SYSTEM OPERATION

### Recommended Amplification

-

### System Controller

Ohm DSP Solutions

### Speaker Cables

Min - 2 x 1 mm<sup>2</sup>

Recommended 2 x 1.5mm<sup>2</sup>

## PRODUCT FEATURES

### Components

1 x 5" Coaxial Low Frequency Driver

### Crossover

Passive - 4 kHz

LPF -

HPF -

## Connectors

Spring loaded terminal

## Dimensions (mm) (Ø x h)

Ø203 x 145

## Hole Cutout (mm Ø)

Ø170

## Ceiling Thickness (mm)

10 - 35

## Weight (kg)

1.7

## Shipping Weight (kg)

2.2 (1 cabinet per carton)

## Colour

White Ral9003

## Options

Available in white or Ral colours on request)

## Rigging

-

## HARDWARE

### Fitted as Standard

-

### Additional Descriptive Data

Attractive white colour ABS resin finish with complementary off white grill suits any decor, Ohm logo.

## Installation Instructions

The installation of this OHM product couldn't be easier:

1. Ensure there is enough clear space to house the speaker.
2. Take the template provided, position on the ceiling at the point where the speaker will be fitted, draw around the circle and cut a hole in the ceiling to fit.
3. Remove the grill from the speaker by gently pushing the mounting poles down until they ease the grill out, position the rear of the speaker facing into the hole. ( fig. 1)
4. Connect speaker to amplification/system ensuring all connections are correct. (fig. 2)
5. Turn the plastic fixing points until the ends are located over the ceiling, tighten the screw until the speaker is clamped on to the ceiling. (fig. 3)
6. Replace the speaker grill. (fig. 4)
7. Turn on music source and enjoy the amazing sound of the OHM loudspeaker.

## Mounting Instructions

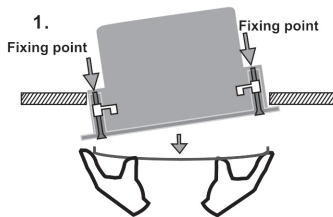

Fig.1

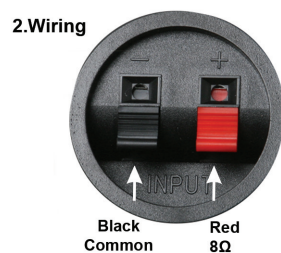

Fig.2

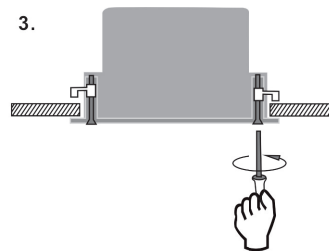

Fig.3

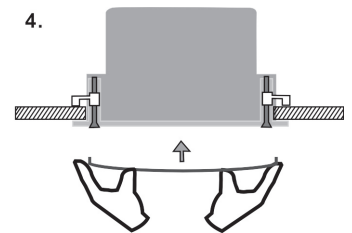
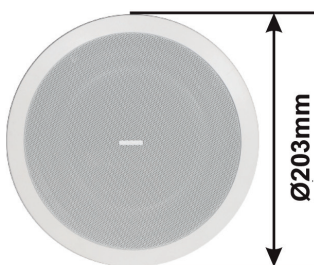

Fig.4

Overall Diameter



Mounting Diameter



Depth



## CL-1TD Dimensions

